

SKD house connection box 250A, DIN1



See below:

**Approvals and Compliances**

**Description**

- Glass fiber Polyester
- Difficult to burn
- Impact resistant

**Unique Selling Proposition**

- cover detachable or hinged
- Cover fastening with 2 sealing screws, 4-kant 8mm

**Characteristics**

- Connection technology screw M10 (max. 20Nm), bride M6 (max. 3.5Nm)
- Protection 2-piece, transparent and sealable
- N-connector for TN-C to TN-S
- N-connector separating Piece self-opening when loosening the screw
- Neutral conductor screw: Tightening torque max. 2.5 Nm
- hand plate with voltage test possibility
- breaking possibility for M20 directly on the housing
- 2 pcs. handle on request

**References**

Last order date: 30.04.2026

**Weblinks**

[pdf data sheet](#), [html datasheet](#), [Detailed request for product](#)

**Technical Data**

Rated Current Ie	250 A @ 500VAC	Rated Impulse Withstand Voltage Uimp	6kV
Rated voltage Ue	500VAC	Conditioned Rated Short Circuit Current	50kA @ 500VAC
Rated isolation voltage Ui	1000VAC	Rated short-time withstand current with fuse links	50kA @ 690VAC
Rated Power Operating Frequency fe	50Hz	Allowed Ambient Temperature	-25°C to +40°C acc. to IEC 61439
		Protection by closed housing	IP54

**Terminals**

NH-Fuse-Links with screw terminal for cable lug	M10	Neutral Disconnector with Straps	16 - 240 mm <sup>2</sup>
Fuse Element with double terminals strap	16 - 240 mm <sup>2</sup>	Earth Connection Bride	6 - 95 mm <sup>2</sup>

**Approvals and Compliances**

Detailed information on product approvals, code requirements, usage instructions and detailed test conditions can be looked up in [Details about Approvals](#)

**Compliances**

The product complies with following Guide Lines

Identification	Details	Initiator	Description
	<a href="#">CE declaration of conformity</a>	SCHURTER AG	The CE marking declares that the product complies with the applicable requirements laid down in the harmonisation of Community legislation on its affixing in accordance with EU Regulation 765/2008.
	<a href="#">UKCA declaration of conformity</a>	SCHURTER AG	The UKCA marking declares that the product complies with the applicable requirements laid down in the British Amendment of Regulation (EC) 765/2008.
	<a href="#">REACH</a>	SCHURTER AG	On 1 June 2007, Regulation (EC) No 1907/2006 on the Registration, Evaluation, Authorization and Restriction of Chemicals 1 (abbreviated as "REACH") entered into force.

## Dimensions [mm]

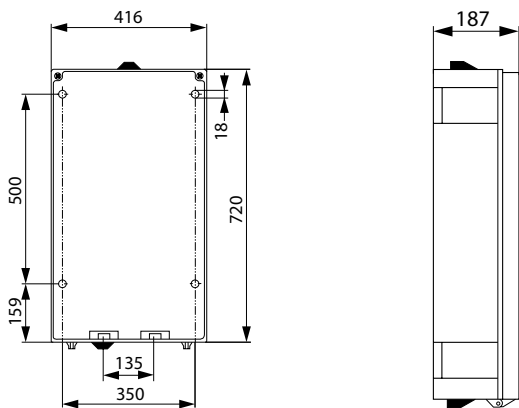

## Variants

Designation	Terminal	Order Number	E-No.
SKD 250A DIN1+0	screw/bride	0009.2350	-
SKD 250A DIN1+0	screw/screw	0009.2351	-
SKD 250A DIN1+0	bride/bride	0009.2352	-
SKD 250A DIN1+0+E	screw/bride	0009.2356	-
SKD 250A DIN1+0+E	screw/screw	0009.2357	-
SKD 250A DIN1+0+E	bride/bride	0009.2358	-
SKD 250A DIN1+0 / 2KE	screw/bride	0009.2353	1)
SKD 250A DIN1+0+E / 2KE	screw/bride	0009.2359	1)
SKD 250A DIN1+0 / 2KE	screw/screw	0009.2354	1)
SKD 250A DIN1+0 / 2KE	bride/bride	0009.2355	1)

Availability for all products can be searched real-time: <https://www.schurter.com/en/info-center/support-tools/stock-check-distributors>

1) 2 cable entries

## Packaging unit

1 Pcs

## Accessories

### Description



hinge\_SKD\_250\_400A  
 hinge for SKD 250/400A